



SET 01/OG



SET 01/OO



SET 01/GO



SET 01/GG

## DIMENSIONS

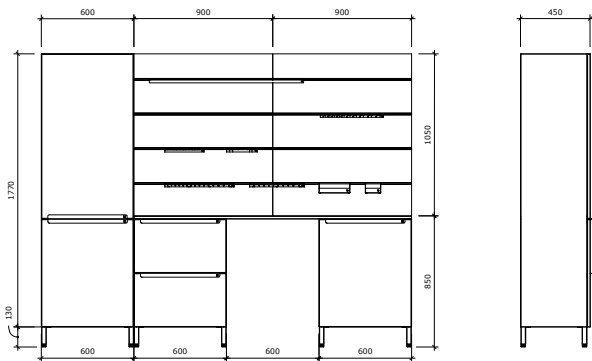

Set includes: standing locker SL\_01 - 1 pc, standing locker SL\_02 - 1 pc, standing locker SL\_03 - 1 pc, panel P1\_90 - 2 pcs, board- 1 pc, hanging shelf HS\_01\_100 - 1 pc and set of boxes and penants.

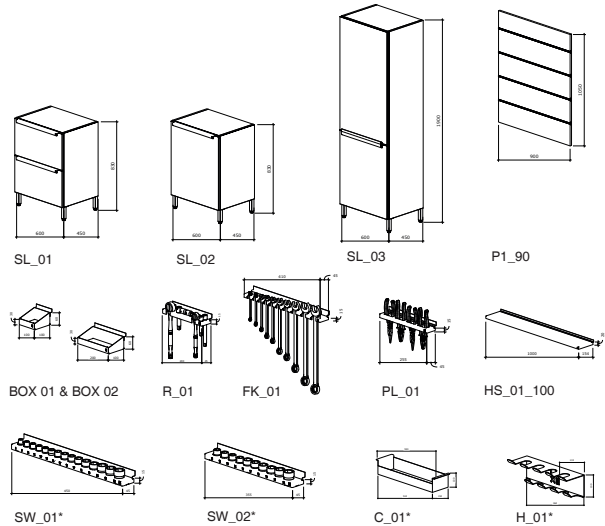

\*CUSTOM ITEMS

## MDF (MR)

Furniture elements are made of a moisture-resistant MDF (MR) melamine faced board covered with a multi-layer coating film. The material is resistant to swelling, ideal for use in closed rooms with moderate air humidity, e.g. in garages and bathrooms. At LYX, we also provide greater protection of the board edging against water penetration by using ultra-modern polyurethane adhesives when applying the ABS protective edge. The entire furniture structure, fronts and wall panels are made of 18 mm thick board.